

Hygienic E7.3 | 1200 x 800

Hygienic Pallet V3
Hygienic Pallet V3 CR



Fully closed hygienic pallet in Euro dimensions

For many years now, the Hygienic E7.3 has struck the perfect balance between mechanical performance and hygiene requirements. Manufactured exclusively from food-grade HDPE – no metal reinforcements – this pallet has become the standard in many industries across Europe. This fully closed pallet has no cavities, making it impossible for dirt to accumulate. Very easy to clean.

Bottom support



> 9 feet (9F)



> 3 runners (3R)



> 3 fully closed runners (3CR)



Special angle permitting easy stretch wrapping

Deck options



> closed deck (CD)



H1-GD version for E2 crates



Several color options

Technical data*1

| | Previous name | Bottom support | Top deck | Dimensions [mm] | Load capacities*2 [kg] | | | Weight [kg] | |
|------------------------|-----------------------|------------------------|------------------|------------------|------------------------|---------|---------|-------------|----|
| | | | | | Static | Dynamic | Racking | HDPE | PO |
| Hygienic E7.3 (CD-9F) | Hygienic Pallet V3 | 9 feet | closed | 1200 x 800 x 155 | 4000 | 1000 | 250 | 17,0 | - |
| Hygienic E7.3 (CD-3R) | | 3 runners | | | | 2000 | 1000 | 18,0 | |
| Hygienic E7.3 (CD-3CR) | Hygienic Pallet V3 CR | 3 fully closed runners | 1200 x 800 x 157 | 5000 | 2500 | 1250 | 19,0 | | |

Entry: 4 ways | Nesting height: - | Safety rim: 6 mm (optional without)

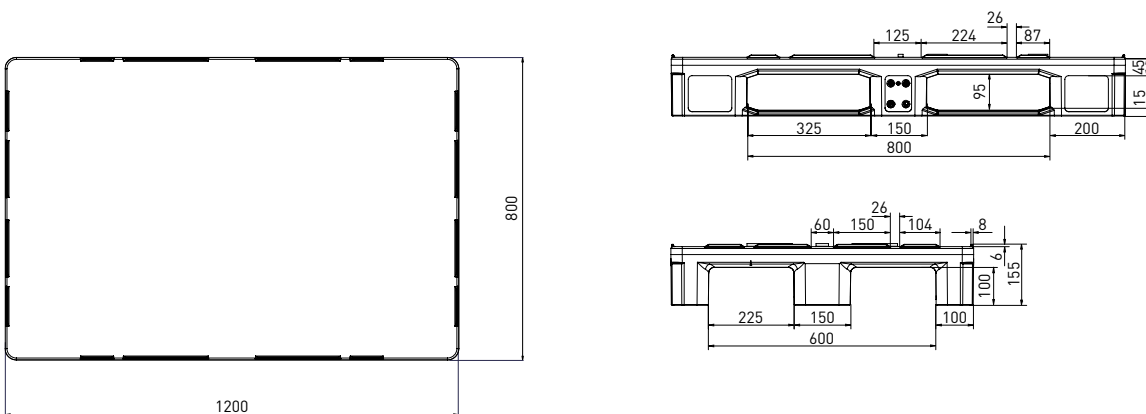

nominal sizes in mm

Options

- Color: (other colors on request*3) > Individual marking*3
- Closed runner Version only > RFID transponders
- Anti-slip: safety rim, strips on deck, strips under deck, strips under blocks > Fire retardant
- ESD prevention: anti-static, conductive



*1 Figures can vary depending on the raw material used and options applied. *2 Guideline values are based both on experience and parts of test ISO 8611, which tests with evenly distributed loads at room temperature (20°C). Varying data may result from different conditions of usage. Your specific requirements can be identified upon request. *3 Minimum quantity required - PO pallets should only be used and stored in a dry environment. We reserve the right to change any of the stated information without prior notice.